



GSM/UMTS/LTE ANTENNA

Antenna LTE OMNI OM58,
690-2600 MHz, 5 dBi, SMA(m),
Cable .195/3m

AO-ALTE-OM58

SECTRON company offers a wide portfolio of GSM/UMTS/LTE antennas with various versions differing in shape, level of gain and manner of attachment. SECTRON guarantees a compatible connection between an antenna and all antenna adaptors produced by SECTRON.

BENEFITS

- Easy installation
- High frequency range
- Low VSWR
- IP67



FEATURES

AO-ALTE-OM58

Technology	GSM/UMTS/LTE
Frequency bands	700/800/850/900/1700/1800/1900/2100/2300/2500/2600MHz
Bandwidth	-
Gain	5 dBi
VSWR	<1.9:1
Impedance	50 Ohm
Directivity	Omnidirectional
Beam angle	Attached graphs below
Polarization	Linear
Maximum input power	10 W
Power voltage	-
Dimensions	∅ 20 x 269 mm
Weight	750 g
Operating temperature	-40 to +60 °C
Execution	External
Method of attachment	Screw Mount
Cable type	.195
The cable length	3000 mm
Connector type	SMA(m)
Certification	RoHS, IP67

DRAWING

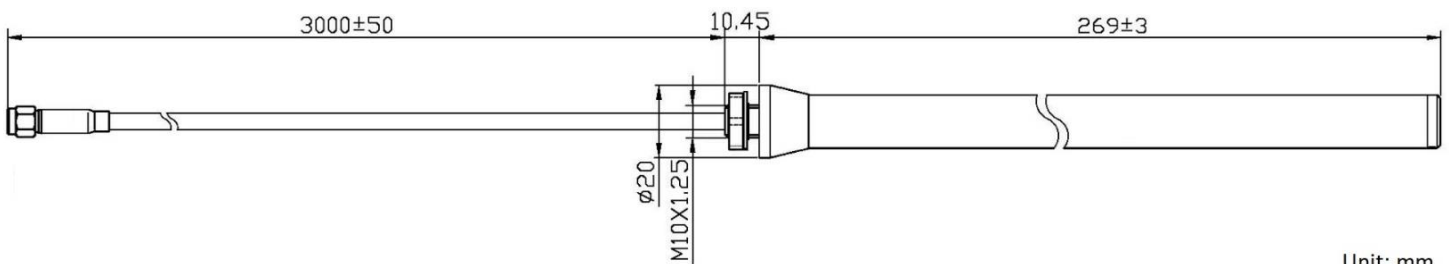

S_{11} - Return Loss [dB]

S11 Refl LoadM RefLvl: 0 dB Res: 10 dB/Div

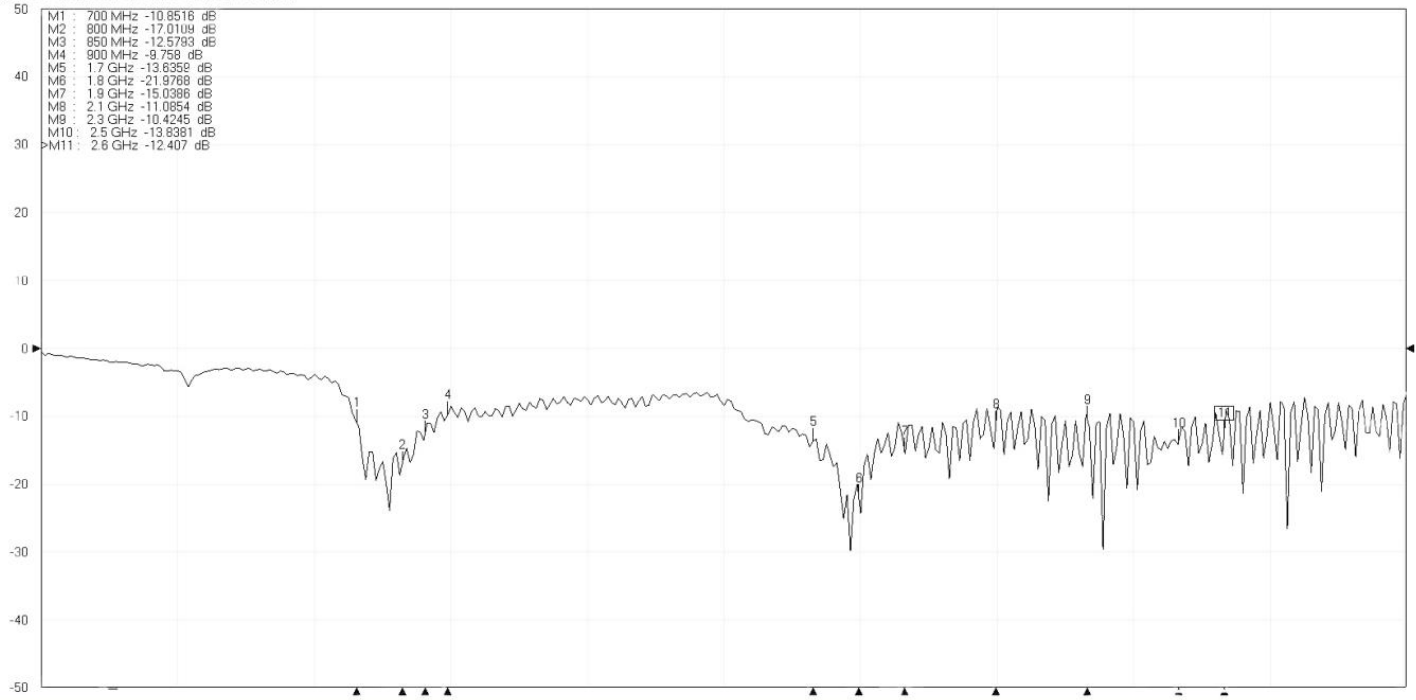

Ch1 TR Start 10 MHz Stop 3 GHz IFBW 1 kHz Avg OFF Measuring State UNCORR

VSWR – Voltage standing wave ratio [-]

S11 Refl SWR RefLvl: 6 U Res: 1 U/Div

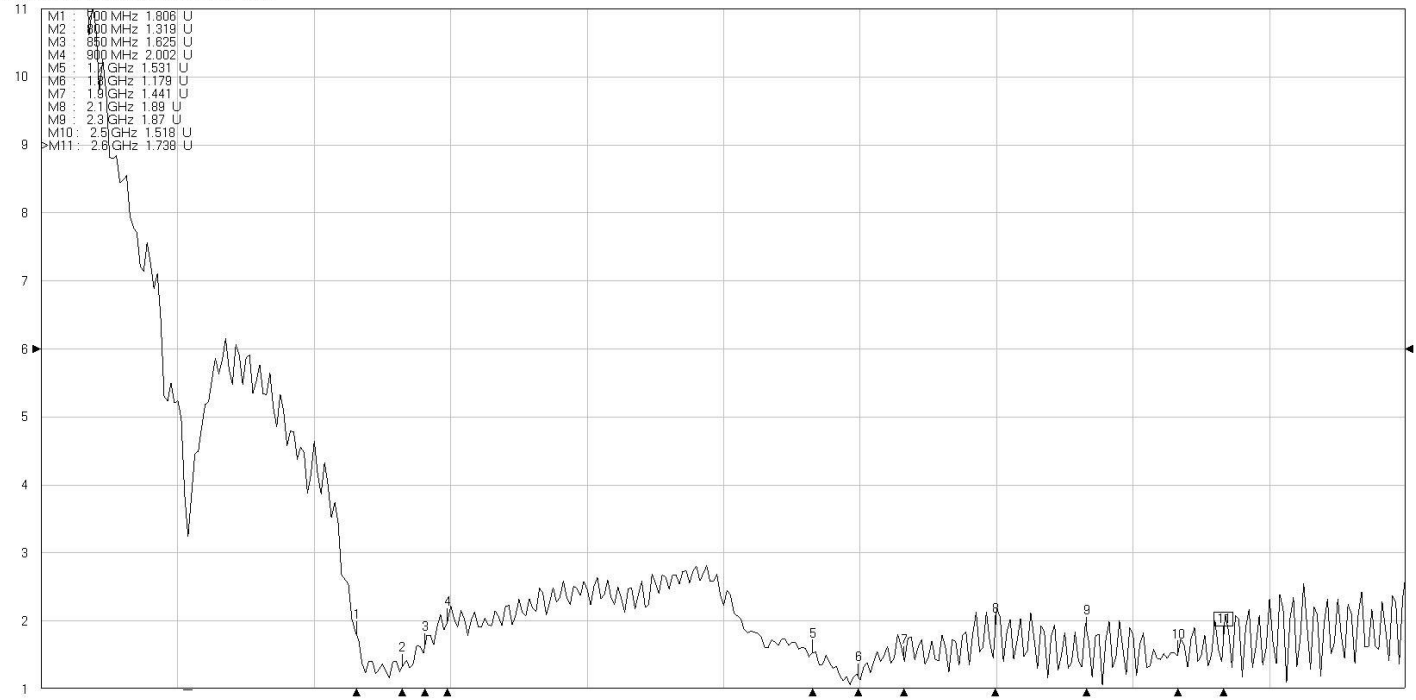

Ch1 TR Start 10 MHz Stop 3 GHz IFBW 1 kHz Avg OFF Measuring State UNCORR

2D RADIATION PATTERN

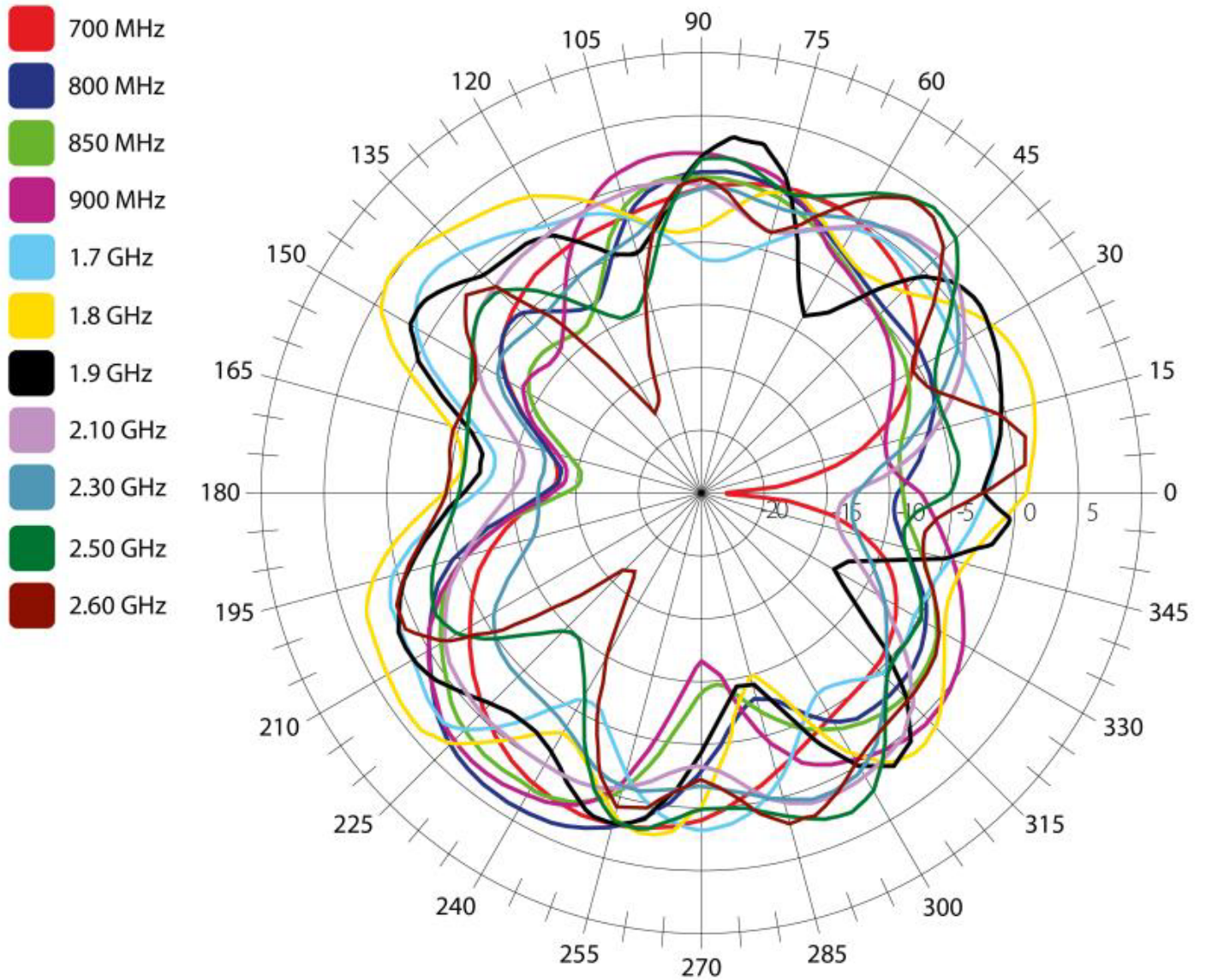

Frequency [MHz]	S_{11} [dB]	VSWR [-]	Gain [dBi]	Efficiency [%]
700	-10.85	1.80	2.29	73.11
800	-17.01	1.31	4.04	74.82
850	-12.57	1.62	2.23	57.41
900	-9.75	2.00	3.52	76.74
1700	-13.63	1.53	3.09	81.28
1800	-21.97	1.17	5.16	111.43
1900	-15.03	1.44	3.22	80.35
2100	-11.08	1.89	1.78	74.99
2300	-10.42	1.87	1.26	60.95
2500	-13.83	1.51	4.09	87.9
2600	-12.40	1.73	3.26	69.34

Different connector variants or cable lengths are available on request.

SECTRON s.r.o. Josefa Šavla 1271/12
709 00 Ostrava 9, Czech Republic

WWW.SECTRON.CZ
Tel.: +420 556 621 020